

Shelf support



- ▶ Shelf support mount with tilt compensator
- ▶ For concealed installation behind the shelf
- ▶ On walls of corresponding quality and with a maximum distance of 600 mm between supports, as well as shelf dimensions of 1000 x 350 mm, the max. load equals 50 kg/m²
- ▶ Steel, galvanised
- ▶ The material quality and condition of walls, supports and attachment are beyond our control. These must be reconciled with the load capacity.

Set comprises:

- ▶ 2 shelf supports

Order no.	PU
9 131 119	1 set

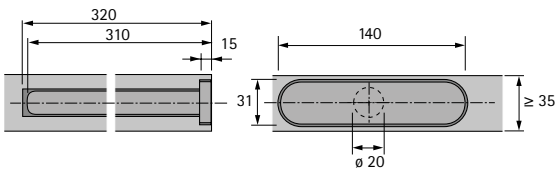

Pull-out shelf support TT



- ▶ Shelf support mount for shelves
- ▶ Stainless steel look
- ▶ The material quality and condition of walls, supports and attachment are beyond our control. These must be reconciled with the load capacity.

Set comprises:

- ▶ 2 pull-out shelf supports

Finish / colour	Order no.	PU
Stainless steel look	9 131 118	1 set

