

Fast-assembly concealed hinge with integrated soft-close function sensys 8639i Opening angle 95°

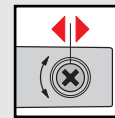
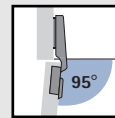

- Concealed hinge for snap-on attachment
- For door thicknesses of 15 - 28 mm
- Cup diameter 35 mm
- With self-closing feature
- Integrated overlay adjustment ± 2 mm
- Integrated depth adjustment $+ 3$ mm / $- 2$ mm
- Height adjustment at mounting plate
- Hinge cup/arm: nickel-plated steel

Cup versions

Cup TH 52
Screw on

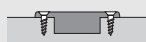

Cup TH 53
Press-in version



Cup TB 53
Press-in version

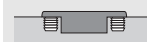

Hinge versions

Mounting options

Article/Order no.

Full overlay

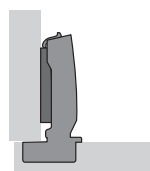

8639i - TH 52
9 084 995

8639i - TH 53
9 084 998

8639i - TB 53
9 085 013

PU
1/200

Half overlay

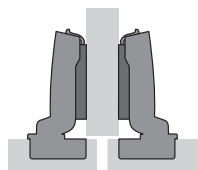

8639i - TH 52
9 084 996

8639i - TH 53
9 084 999

8639i - TB 53
9 085 014

PU
1/200

Inset

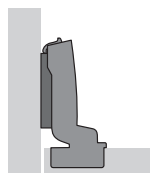

8639i - TH 52
9 084 997

8639i - TH 53
9 085 000

8639i - TB 53
9 085 015

PU
1/200

Hinge-arm cover cap

- Nickel-plated steel

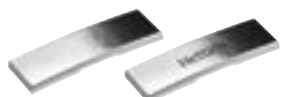

Hinge cup cover cap

- Nickel-plated steel

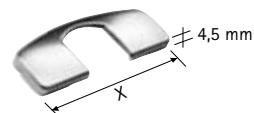

Version	Order no.	PU
without Hettich Logo	9 082 612	1/200
with Hettich Logo	9 082 774	1/200

Cup version	X mm	Order no.	PU
TH 52 / TH 53	68,2	9 082 614	1/200
TB 53	61,4	9 084 924	1/200



Cup distance C mm	Door thickness mm													
	15	16	17	18	19	20	21	22	23	24	25	26	27	28
Minimum reveal per door – allow for in distance calculation														
Table entries apply to doors with 0 mm radius														
3	0,3	0,5	0,6	0,8	1,1	1,4	1,9	2,6	3,4	4,3	5,2	6,1	7,0	7,9
4	0,3	0,5	0,6	0,8	1,0	1,3	1,7	2,3	3,0	3,8	4,7	5,5	6,4	7,3
4,5	0,3	0,5	0,6	0,8	1,0	1,3	1,7	2,2	2,9	3,6	4,5	5,3	6,2	7,0
5	0,3	0,4	0,6	0,8	1,0	1,3	1,6	2,1	2,7	3,4	4,2	5,0	5,9	6,7
6	0,3	0,4	0,6	0,8	1,0	1,2	1,6	1,9	2,4	3,1	3,8	4,6	5,4	6,3

The minimum reveal is reduced for a door thickness of, for example, 22 mm with radii:
1 mm radius: table entry – 0,4 mm
3 mm radius: table entry – 1,0 mm

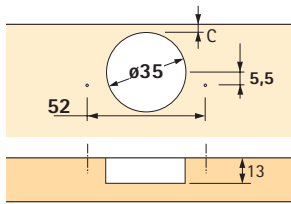

TH 52 hole dimensions

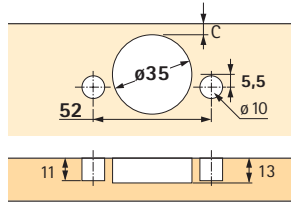

TH 53 hole dimensions

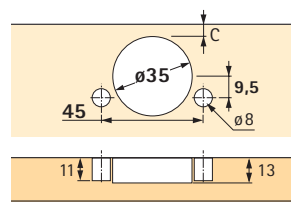

TB 53 hole dimensions

Hinge protrusion H/
door protrusion T
for 0 mm distance
and 3 mm
cup distance

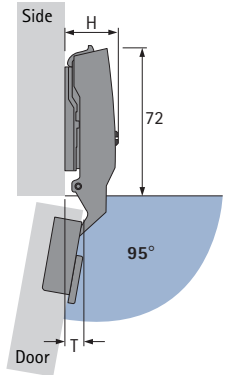

Mounting option	H mm	T mm
Overlay	25,0	7,5
Centre panel	31,0	17,0
Inset door	38,0	24,0

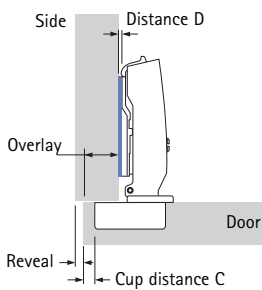

Cup distance C mm	Overlay mm								
	10	11	12	13	14	15	16	17	18
Distance D mm									
3	5,5	4,5	3,5	2,5	1,5	0,5			
4	6,5	5,5	4,5	3,5	2,5	1,5	0,5		
4,5	7,0	6,0	5,0	4,0	3,0	2,0	1,0		
5	7,5	6,5	5,5	4,5	3,5	2,5	1,5	0,5	
6	8,5	7,5	6,5	5,5	4,5	3,5	2,5	1,5	0,5

Overlay adjustment ± 2,0 mm

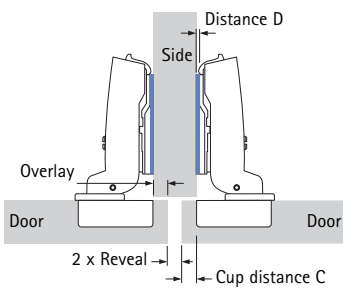

Cup distance C mm	Overlay mm								
	0,5	1,5	2,5	3,5	4,5	5,5	6,5	7,5	8,5
Distance D mm									
3	5,5	4,5	3,5	2,5	1,5	0,5			
4	6,5	5,5	4,5	3,5	2,5	1,5	0,5		
4,5	7,0	6,0	5,0	4,0	3,0	2,0	1,0		
5	7,5	6,5	5,5	4,5	3,5	2,5	1,5	0,5	
6	8,5	7,5	6,5	5,5	4,5	3,5	2,5	1,5	0,5

Overlay adjustment ± 2,0 mm

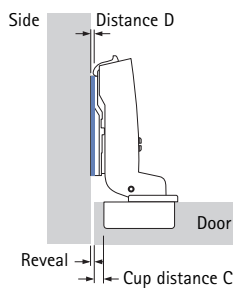

Cup distance C mm	Door thickness mm													
	15	16	17	18	19	20	21	22	23	24	25	26	27	28
Distance D mm														
3					0,1	0,4	0,9	1,6	2,4	3,3	4,2	5,1	6,0	6,9
4	0,3	0,5	0,6	0,8	1,0	1,3	1,7	2,3	3,0	3,8	4,7	5,5	6,4	7,3
4,5	0,8	1,0	1,1	1,3	1,5	1,8	2,2	2,7	3,4	4,1	5,0	5,8	6,7	7,5
5	1,3	1,4	1,6	1,8	2,0	2,3	2,6	3,1	3,7	4,4	5,2	6,0	6,9	7,7
6	2,3	2,4	2,6	2,8	3,0	3,2	3,6	3,9	4,4	5,1	5,8	6,6	7,4	8,3

Reveal adjustment ± 2,0 mm

Mounting plates, see pages 42 – 43
Technical information, see pages 12 – 13